

# Mechanical Limited-Slip Differential

The mechanical limited-slip differential (mLSD) adds extra capability to front-wheel drive Transit variants to suit adventurous business and private customers. The robust system enhances traction in challenging conditions and terrain.



## Compact, reliable solution

The mLSD offers customers improved traction without compromising Transit's load carrying ability, efficiency or dependability.

- Smooth, seamless, progressive operation
- No additional driver inputs required
- Does not affect load area, fuel efficiency or CO<sub>2</sub> emissions
- Lightweight design
- No additional servicing requirements
- Already proven in demanding Ford Performance applications

## Improved capability

The new mLSD allows Trail and Active vehicles to more comfortably tackle unpaved roads, gravel tracks and rugged or challenging surfaces. For optimum performance, the Electronic Stability Control has been recalibrated to harmonise with the mLSD for smooth progress.

- Simple, mechanical design integrated into existing drivetrain
- Developed in partnership with driveline specialists Quaife
- Helical gears in the mLSD mesh together during normal, on-road driving
- Automatically sends torque to the wheel with most grip on loose surfaces



# FORD TRAIL & ACTIVE SERIES

## Optional mLSD

The mLSD is optional on Active series vehicles fitted with Ford's smooth six-speed manual gearbox.

- Transit Custom Active
- Tourneo Custom Active
- Transit Connect Active
- Tourneo Connect Active

## Standard-fit mLSD

- Transit Trail
- Transit Custom Trail

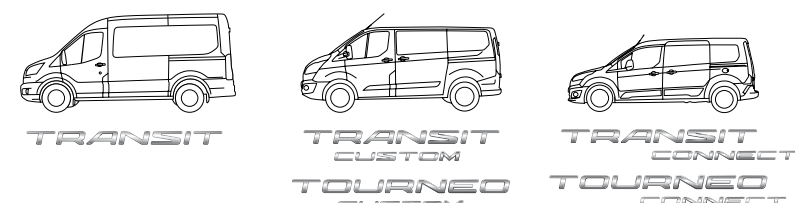
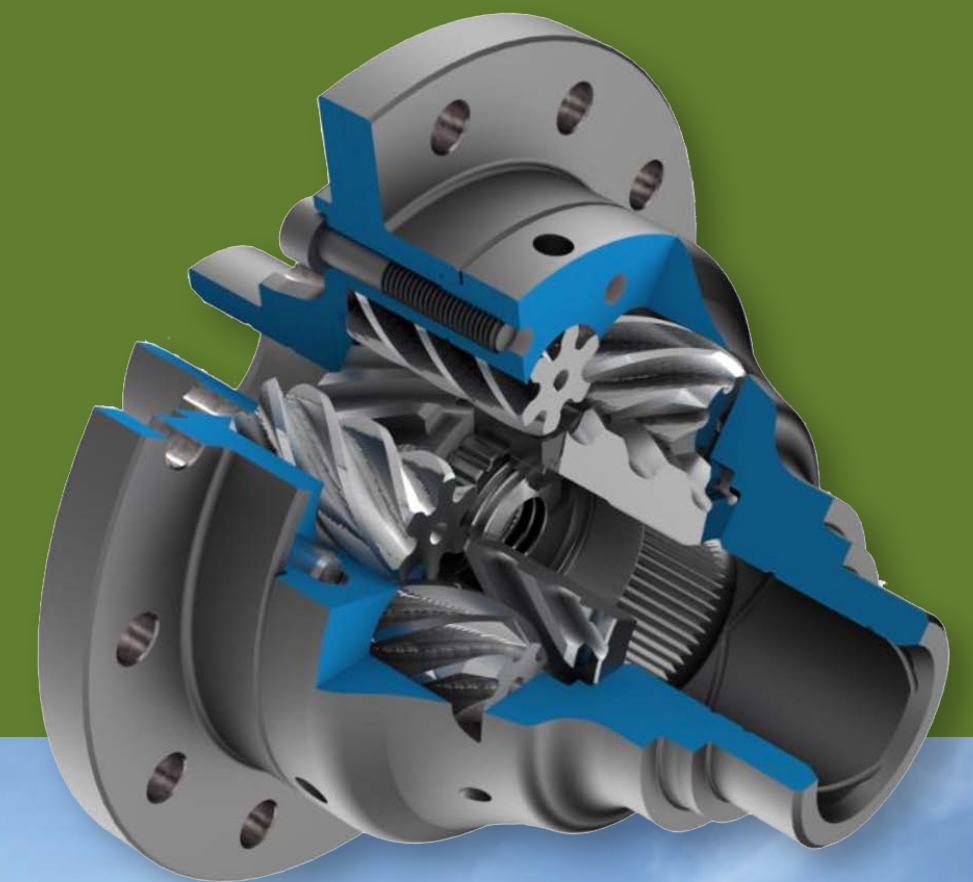

**>> For more information please visit**  
[transittourneotrailactive.fordpresskits.com](https://transittourneotrailactive.fordpresskits.com)

**▶ Watch the video:**  
[transittourneotrailactive.fordpresskits.com/?p=mm&t=mlsd](https://transittourneotrailactive.fordpresskits.com/?p=mm&t=mlsd)